

Mollybather



user guide

IMPORTANT :  
Please read this manual thoroughly before use  
This product is protected under Patent : GB 2366722



Mollybather



user guide

IMPORTANT :  
Please read this manual thoroughly before use  
This product is protected under Patent : GB 2366722



## **WARNING**

- Please read this handbook thoroughly prior to using your Molly Bather.
- Release the GREY ‘Down’ button on the handset at the bottom of the bath.
- Recharge the battery when the RED light on the handset is illuminated, or once a week.
- Sit centrally on the belt and do not lean back when moving.
- Release RED ‘Up’ button when the belt is level with the padded seat.
- Ensure the belt bar is placed correctly into the grab rail cradle, wound to the right setting for the width of your bath.
- Do not raise or lower the belt without weight applied and check that the belt is taut before use.

### **Page 3 - Getting started**

- Understanding your Molly Bather.

### **Pages 4 - 6 - Using your**

- How to transfer into and out of the bath.
- Operating your Molly Bather.
- Handset control.

### **Pages 7 - 9 - Product care**

- Battery care.
- Belt care.
- Troubleshooting.

### **Page 10 - After Care information**

- Warranty details.
- Technical specifications.
- Spare part references.
- Contact details.

### **Page 11 - Notes**

## **Molly Bather Limited**

49A Littlemarsh, Semington, Trowbridge, Wilts. BA14 6JF, United Kingdom  
 tel: 01380 870649 fax: 01380 871056 email: sales@mollybather.com



# Specifications

## Warranty terms and conditions

Your Molly Bather has a 12 months parts warranty from date of purchase, providing it has been installed and used as instructed in this manual. Whilst most of the components in your bath lift are made from anti-corrodable materials, using your Molly Bather with a salt-based water softener could shorten it's lifespan and should be avoided. Regular drying of the bath lift and grab rail surfaces after use will help enhance the life of your Molly Bather. The slip-cushion should be washed as per our instructions regularly to avoid bacteria and mildew forming.

## Service record

12 months service	24 months service	36 months service	48 months service
-------------------	-------------------	-------------------	-------------------

## Product specification

Item	Specification
Maximum user weight	140kg / 308lb / 22st
Seat height	Min: 50cm / 20" - Max: 62cm / 24½"
Seat size	Width: 46cm / 18" x Depth: 22cm / 8½"
Belt width	28cm / 11"
Lift range	43cm / 17"
Bath width suitability	Min: 65cm / 25" - Max: 85cm / 33"
Bath height suitability	Min: 46cm / 18" - Max: 58cm / 23"
Battery	12vDC x 2.1aH Gel
Battery range	20 lifts average between charge
Battery charge duration	8 to 10 hours (overnight)
Battery weight	1.5kg / 3.3lb
Bathlift weight (exc. battery)	12.5kg / 27.5lb

## Spare parts

Item	Specification
BAT	Replacement Molly Bather battery
CHARGE-UK	Replacement Molly Bather battery charger - UK
SC140W	Replacement Molly Bather slip-cushion WHITE
SEAT-W	Replacement Molly Bather padded stool seat - WHITE
BELT	Replacement Molly Bather bathing belt

## Contact details

### Molly Bather Limited

49A Littlemarsh, Semington, Trowbridge, Wilts. BA14 6JF, United Kingdom  
 tel: 01380 870649 fax: 01380 871056 email: sales@mollybather.com

# Getting started

## Understanding your Molly Bather

NOTE: The rating of the Molly Bather is 140kg (22stones), which must not be exceeded. Your Molly Bather is installed next to a wall beside your existing bath.



The grab rail has been securely fixed to the wall directly opposite the floor-mounted seat. The grab rail additionally acts as a wall support for the fixed end of the bathing belt. The belt can be removed from the grab rail allowing others to use the bath normally.



The handset controls are waterproof and can be used in and out of the bath.

Pressing the red (right) button raises the bathing belt, while pressing the grey (left) button lowers the bathing belt.

Above the handset buttons is a lamp which illuminates when the battery needs charging.



A padded seat is fitted above the main unit.

The seat edges protrude out to form a hand hold to aid transfer. The padded seat is hinged upwards to access the rechargeable battery. The battery must be charged outside the bathroom using the charger supplied.

Charge the battery fortnightly or when the red light illuminates on the handset. **Leave overnight for a full charge.**



# Using your Molly Bather

## How to transfer into and out of the bath

**1** It is vital you understand how to transfer safely into and out of the bath when using your Molly Bather.



### IMPORTANT

To prevent falling backwards ensure you hold on to the grab rail, and do not lean backwards whilst moving.

You may be supple enough merely to step in and out of your bath, using the Molly Bather only to lower you to a comfortable height for bathing and raising you to step out. However, if needed, the Molly Bather has also been designed to allow safe and comfortable transfer for those who need more help.

The recommended procedure for those needing more help is as follows:

### NOTE

Secure the limpets of the handset inside the edge of the bath, leaving the top edge clear for you to swing your legs over. The handset will now be close at hand.

**2**



### Lowering to the bottom of the bath

**1.** Sit on the padded seat facing away from the bath. (This is ideal for undressing).

**2.** Holding on to the edge of the padded seat, swing yourself so your legs are against the side of the bath. Reach for the grab rail with your other hand.

**3.** Holding on to the edge of the padded seat and the grab rail, swing your legs over the bath side and into the bath.

**4.** Again, holding on to the edge of the padded seat and the far edge of the slip cushion, position yourself centrally on the slip cushion.

**NOTE:** If you are not using a slip cushion hold the edge of the padded seat and the grab rail, slide yourself onto the belt, staying as close to the padded seat as possible at this stage.

**3**



**4**



# Product care-Troubleshooting

## Troubleshooting tips

In the unlikely event that your Molly Bather develops a technical fault or is performing below its original specification, please refer to the table on the right, prior to contacting your supplier for assistance.

### Important tips for reliability

1. Ensure the battery is charged weekly for optimum performance.
2. Ensure the belt and slip cushion are regularly cleaned and allowed to dry naturally.
3. We recommend your AquaLift is serviced every 12 months. (Refer to the 'Contact' section for details).

This will ensure your bathlift and building attachments are safe and reliable.

### NOTE

Please contact us if you are unsure how to use your Molly Bather correctly or the suggested Troubleshooting tips have not rectified the fault.

SYMPTOM	CAUSE	SOLUTION
Red lamp on handset lit	Battery low	Recharge battery
Red lamp on handset flashing	Battery very low	DO NOT USE until battery is charged
Belt is very slack when fully raised	Incorrect width setting	Readjust as page 8
Belt is too taut when fully raised	Incorrect width setting	Readjust as page 8
Belt has an odour or is grimy	Not regularly cleaned / dried	See page 8 for instructions
Motor struggling during lift	Battery low	Recharge battery
	Service required	Contact your dealer
Unusual noises from motor	Service required	Contact your supplier
Belt showing signs of fraying or serious damage	Service required	Contact your supplier
Belt creased	Belt being wound incorrectly	Sit upright when raising or lowering
Belt raises when Grey button pressed	Belt wound up in reverse	Contact your supplier
Belt will not raise or lower	Electronics fault or Belt wound up in reverse	Contact your supplier
	Battery very low	Recharge battery
Seat height altered	Leg adjustment loose	Contact your supplier

## Product care - Belt

### Belt care

#### Belt attachment and removal

A stainless steel bar is attached to the fixed end of the bathing belt, the excess belt is wound around the bar until the belt is relatively taut. (The white label will normally be level with the grab rail).

Note the marking of the belt label, it will indicate either 'MIN', 'MID' or



'MAX' depending on your bath width. We will have set this for you initially, but you will need to remember which is best for you.

The belt can be removed from the grab rail for cleaning or for others to use the bath,

but when refitting, ensure the belt is fully 'raised', and that the belt is fitted back into the grab rail cradles correctly, wound to the same width setting as before.

**DO NOT SET THE BELT TOO TAUT.**

#### Belt cleaning

The bathing belt is made from a water-repellent mesh material and is drip-dry.

To clean the belt, please follow this procedure:

**1.** Lower the bathing belt into the empty bath, putting hand pressure on the empty belt to maintain tension at all times.



**2.** Using a damp cloth and anti-bacterial cleaner, wipe down the upper and lower surfaces of the belt.

**3.** Allow to dry naturally while lowered.

**4.** Raise the bathing belt fully, again putting hand pressure on the belt to maintain tension at all times. Check your belt is set to the correct width setting as mentioned earlier.

#### Slip-Cushion cleaning

The slip cushion can be removed by unsecuring the velcro straps. Hand or machine-wash at 40°C. When clean and dry simply re-attach the velcro straps under the belt. Straps should not be too taut to allow it to slide sideways easily.

#### Seat and metalwork cleaning

The padded seat, handset and all the external metalwork can be cleaned using a damp cloth and anti-bacterial cleaner, drying thoroughly afterwards.

Care should be taken to keep moisture away from the battery and the battery chamber connections.

## Using your Molly Bather

### How to transfer into and out of the bath

**5**



**5.** Reach for the handset and press the grey 'down' button to lower yourself into the bath. By leaning slightly towards the grab rail, the slip cushion should keep you central on the lowering belt.

#### NOTE

It is advisable to hold the grab rail when in motion.

**6.** Continue lowering by pressing the grey 'down' button until you reach the bath bottom. Stop lowering and ensure you are sitting in a comfortable position.

If necessary, you can press the grey 'down' button briefly to release the belt tension from your body.

**7.** Store the handset on the bath edge, using the limpets to secure it in place.

Gently lie back in the bath and enjoy a normal soak.

**6**



#### Raising to the top of the bath

**8.** Ensure you are sitting centrally on the slip cushion, hold the grab rail and bring yourself to an upright sitting position. Reach for the handset, (removing from the side of the bath if preferred). Press the red 'up' button to start raising yourself up. By leaning towards the padded seat, the slip cushion should keep you central on the belt.

#### NOTE

It is advisable to keep a hand on the grab rail when in motion.

**7**



#### IMPORTANT

**ALWAYS check you are pressing the RED 'Up' button to raise yourself.**

(If the grey 'down' button is continuously pressed by mistake, it could completely wind out the belt and start winding the belt in reverse. This will render the magnetic belt-stop inoperable).

**ALWAYS check the belt is taut and the belt bar is properly fitted into the grab rail cradles before you use your Molly Bather.**

**8**



# Using your Molly Bather

## How to transfer into and out of the bath

9



### Raising to the top of the bath - continued

9. Continue raising by pressing the red 'up' button until you are level with the seat or the motor stops automatically.

10. Put the handset out of the way, then hold firmly on to the grab rail and padded seat hand hold.

Slide yourself from the belt up on to the padded seat ensuring a firm hold.

11. Holding on to the edge of the padded seat, swing your legs over the side of the bath and on to the floor.

12. Rotate yourself to a comfortable seated position, where you can dry yourself and dress.

10



### Molly Bather handset

The handset shown is marked with 'Up' and 'Down' arrows on the soft rubber buttons, (marked in the photograph below). The right 'UP' button is RED, the left 'DOWN' button is GREY. The cable should always be pointing towards you.

Directly above the buttons there is a red lamp which illuminates when the battery needs charging.

The handset is waterproof and can be safely used in or out of the bath.

11



12

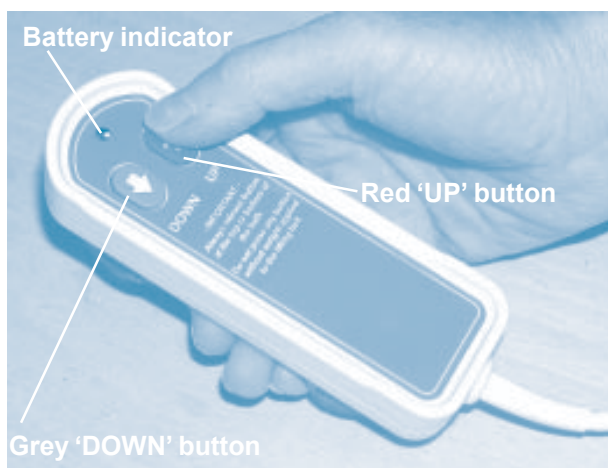

# Product care - Battery

## Battery care



Your Molly Bather has a rechargeable battery, which is fitted below the padded seat and is accessed by holding the edge of the seat nearest the bath and hinging upwards. (As shown left).

The battery has a strap and is pulled upwards to remove and held to lower back into the battery-well.

### NOTE

The battery must be taken outside the bathroom and charged overnight, using the supplied battery charger. (Usually once a week will be adequate).

## Battery charge indication

The handset battery indicator lamp will illuminate when the battery needs charging.

If the battery is **LOW**, the red lamp will **LIGHT** when the grey 'down' button is pressed and stays **LIT**. - It is safe to use the Molly Bather once more, but charge the battery immediately afterwards, leaving overnight.

If the battery is **VERY LOW**, the red lamp will **FLASH** when the grey 'down' button is pressed and stays **FLASHING**. - **It is NOT safe to use the Molly Bather.**

**Charge the battery immediately, leaving overnight before using.**

## Charging the battery

The battery charger lead is fitted with a jack-plug which must be fitted into the chromed socket nearest the curved end of the battery pack. Plug the charger into the mains supply and switch power ON. A red lamp on the charger will **LIGHT**. Leave on charge overnight, or at least for 8 to 10 hours.

After charging, the red lamp on the charger will either be dim or extinguish. The green light will light when the battery is fully charged.

Switch OFF the mains supply at the charger and remove the jack-plug from the battery.

### WARNING

Always pull out by the moulded plug - **NEVER PULL OUT BY THE CABLE.**

## Refitting the battery

Holding the strap, lower the charged battery into the battery-well below the seat. The red lamp on the handset will extinguish when the grey 'down' button is pressed again. If it lights again, lift the battery half-way out and replace back into the battery-well. (This cancels the last checked voltage of the Molly Bather electronics and re-checks the battery voltage).

**Fortnightly charging will prolong your battery life.**